

Uniclass L8456	EPIC Q611
C/SFB (71.1)	X

stealth

Stealth is an elegant and versatile sign system providing a range of distinctive profiles for external signs. The slender lines and durable finish harmonize with both contemporary and traditional environments alike.

Its total flexibility permits a variety of design solutions for wayfinding information and welcomes people with a confident statement of an organizations commitment to quality and design.

Stealth is a one piece aluminium extrusion, available in either an anodised or stove enamelled finish to your colour specification.

With the addition of an internal galvanized steel post, for strength and durability, Stealth can form structures up to 3000mm high.

Double post Stealth 16.5 →
with toughened glass panels.
Monolith Stealth 40. ↓



Stealth is exclusively manufactured in the UK by Signbox Limited. As a design-led sign manufacturer, we are passionate about signs and have a reputation for producing high quality products, which has put us at the forefront in the field of sign systems.



stealth

Combining the elegance of high quality extrusions with a creative approach to typesetting, Stealth can be specified as a single monolith or used as a double post sign.

Graphics are applied using quality 3M vinyls, silkscreened or digitally printed. The use of reflective vinyls is particularly effective for roadside directional signs in locations where power is unavailable.

Sign panels can be manufactured from acrylic, toughened glass, aluminium or timber to achieve the right solution to design requirements. Using our Signkit range of precision engineered components any panel thickness from 1-10mm can be supported.

To create greater impact, ambiance or visibility at night or in darkened environments all Stealth profiles can be illuminated by a durable stainless steel LED fixing. The patented design of the Project Lumos sign support, provides an incredibly efficient light source in a vivid range of colours.

For total security, panels can be securely fastened with anti-vandal fixings that can only be released with an alun key, preventing unwanted tampering or theft. Therefore ensuring your investment is retained for years to come.

With a rated life of some 50,000 hours, Project Lumos is a 'fit and forget' device operating on low voltage DC. The LED's can be specified for internal or external use and edge illuminate acrylic panels up to 10mm thick.



Stealth offers complete design flexibility, available in a range of sizes up to 500mm wide. Larger widths are also available with a bespoke system that complements the gentle curved profile.

The curved profile relates perfectly with many of the curved insert door signs on the market today.

For consistency, Stealth can be employed internally for freestanding wayfinding directories and be suspended or wall mounted.

The simplicity of Stealth is the defining element in the competitiveness of this system. Minimal components combined with a quality finish meet in a fusion of form & function.

stealth:

- Identifier
- orienter
- informer



stealth

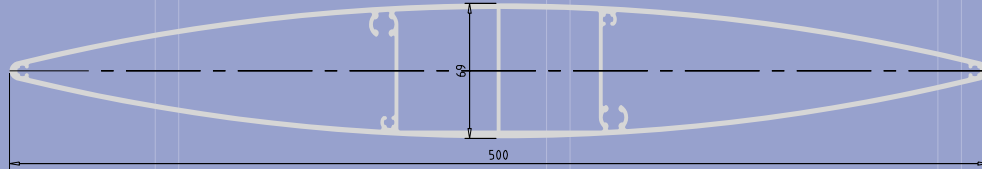

stealth 50

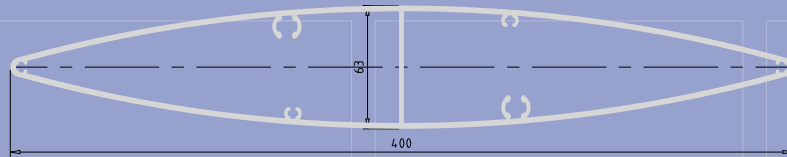

stealth 40

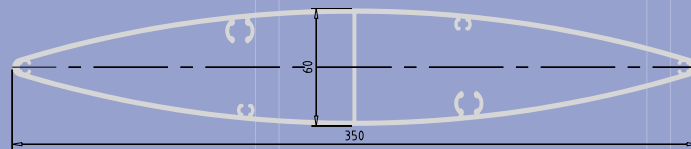

stealth 35

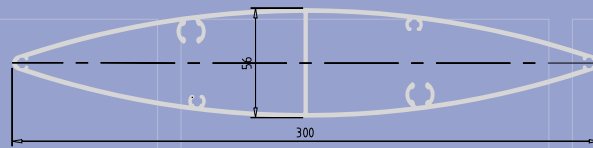

stealth 30

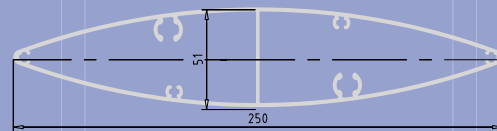

stealth 25

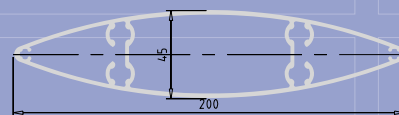

stealth 20

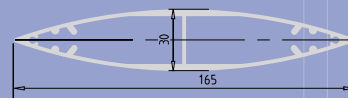

stealth 16.5

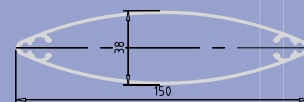

stealth 15

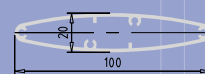

stealth 10

Features & Benefits

Aesthetically pleasing

Stealth is manufactured from extruded aluminium sections with aluminium end-caps all of which can be anodised, stove enamelled or polyester powder coated to match a corporate identity or co-ordinate with the surrounding architecture.

Virtually maintenance free

Stainless steel fixings are used, producing a virtually maintenance free and corrosion-resistant system.

Reduced energy costs

When illumination is specified using LED components, power consumption can be as little as 1W.

Stealth is available in varying widths from 100mm to 500mm as standard. Other sizes can be provided, please contact us for further details.



INVESTOR IN PEOPLE

signbox

Signbox Limited

Unit 3

Egham Business Village

Crabtree Road

Egham, Surrey

TW20 8RB

Tel 01784 438688

Fax 01784 471694

Isdn 01784 435159

enquiries@signbox.co.uk

www.signbox.co.uk